



REGIONAL TRANSPORTATION COMMISSION

Public Transportation • Streets and Highways • Planning

February 1, 2012

Subject: Public Information Meeting for the Moana Lane Widening Project

Dear Property Owner/Business Owner/Resident:

The Regional Transportation Commission (RTC) will be widening Moana Lane from Baker Lane to the I-580 southbound ramps in 2012. The limits of construction are shown on the project location map on the reverse side of this letter. In addition to the widening (one travel lane plus bike lanes will be added in each direction), Moana Lane and the intersections at South Virginia Street and Kietzke Lane will be reconstructed (i.e. complete pavement removal and replacement). Other improvements to be constructed include, but are not limited to, new traffic signals, sidewalk, curb and gutter, as well as landscaping, in the new construction areas. Road construction is anticipated to begin in the second quarter of 2012 and will take approximately eight months to complete.

Currently there is utility replacement and relocation construction occurring in advance of the RTC's project. The utility work will continue throughout the next several months.

Any property owner who is planning to install gas, water or sewer laterals, telephone or television cable, etc., which will require street trenching within the limits of the project, is requested to do so prior to construction. The purpose of this request is to avoid cutting newly constructed pavements and the associated street cut permit penalties typically assessed by the local agency.

The RTC will be providing an opportunity for business owners, property owners and residents to preview the plans and discuss the construction and traffic issues prior to the start of construction. You are cordially invited to attend a public information meeting for this project. **The meeting will be held on February 15, 2012, between 4:30 pm and 7:30 pm in the RTC's Board Room located at 2050 Villanova Drive in Reno, Nevada. A location map is enclosed for your reference.** There will not be a formal presentation so please feel free to drop in at any time between the above mentioned hours to view the plans and receive additional information.

Should you have questions concerning this project, please contact Doug Maloy, RTC Project Manager, at (775) 335-1865 or by e-mail: dmaloy@rtcwashoe.com.

Sincerely,

A handwritten signature in black ink, appearing to read "Jeffrey D. Hale", written over a light blue circular background.

Jeffrey D. Hale, P.E.
Engineering Director

JDH/DMM/lbe
Enclosure

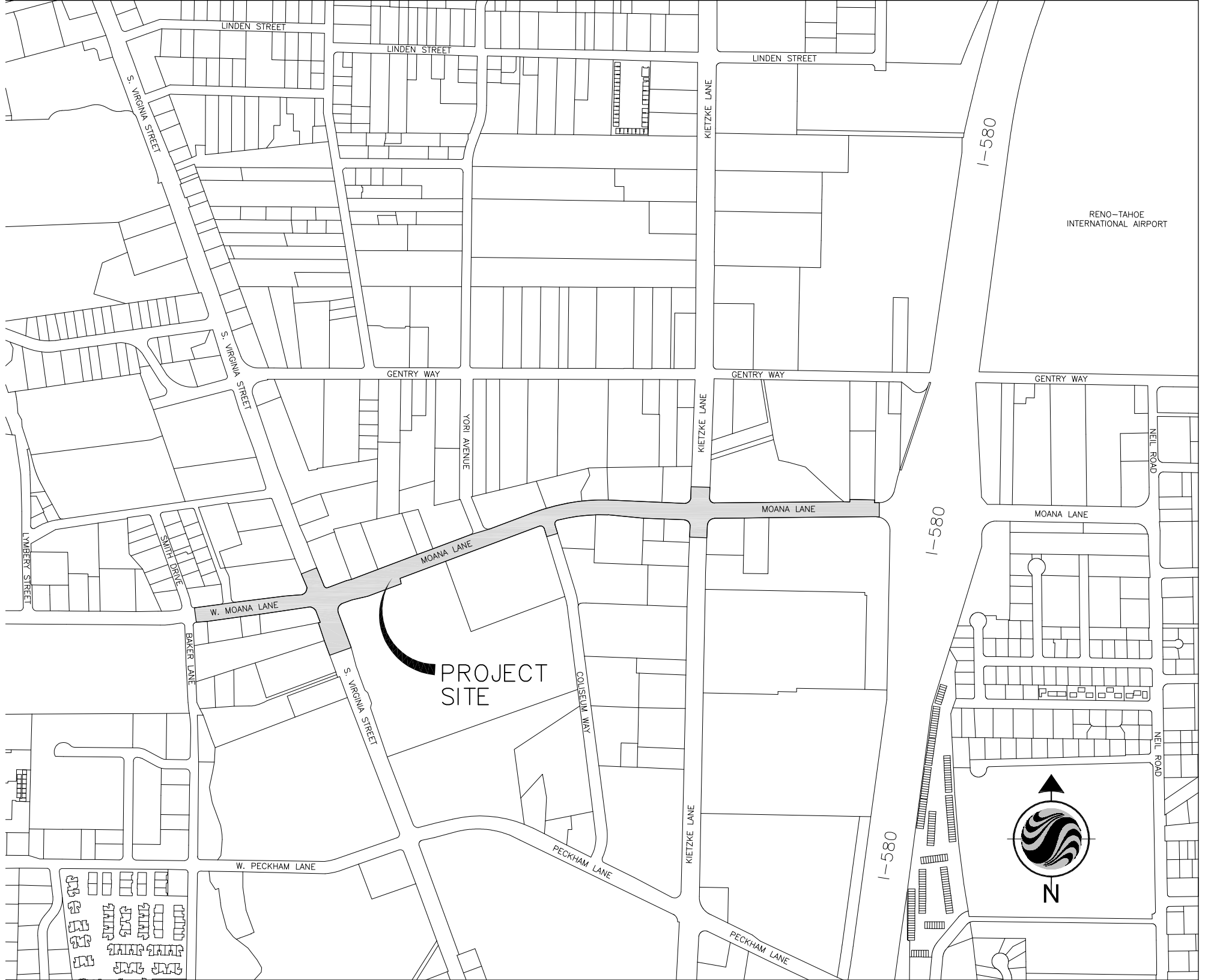

LINDEN STREET

LINDEN STREET

LINDEN STREET

S. VIRGINIA STREET

KIETZKE LANE

I-580

RENO-TAHOE
INTERNATIONAL AIRPORT

GENTRY WAY

GENTRY WAY

GENTRY WAY

YORI AVENUE

KIETZKE LANE

NEIL ROAD

MOANA LANE

MOANA LANE

MOANA LANE

I-580

W. MOANA LANE

PROJECT
SITE

COLISEUM WAY

MOANA LANE

MOANA LANE

NEIL ROAD

S. VIRGINIA STREET

KIETZKE LANE

I-580



PECKHAM LANE

W. PECKHAM LANE

PECKHAM LANE

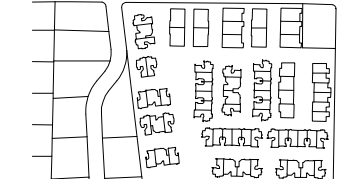



Directions to Regional Transportation Commission, 2050 Villanova Dr, Reno NV 89502

From W Moana Ln, start out going east on W Moana Ln toward S Virginia St.

Merge onto US 395 N via the ramp on the left toward Susanville.

Take Exit 65 toward Plumb Ln / Airport / Villanova Dr.

Keep straight through intersection; ramp becomes Durham Rd.

Just before the intersection light at Durham and Villanova, turn left, then left again (follow signage) into the RTC parking lot. Entrance is directly underneath freeway.

Additional parking is available across Durham in the northwest corner of the Airport Plaza parking lot (spaces marked "RTC").

Served by RIDE Route 19.

